

## Properties for disposal 2015 and beyond

		Sq.Mts	Comments
1	Higher Road Depot, Higher Rd, Urmston	4,049	Depot currently in use but occupier due to relocate. Potential for residential development.
2	Partington Depot, Manchester Rd, Partington	3,263	Former depot part of which currently occupied by Partington Town Council.
3	Woodsend Circle, Flixton	10,750	Regeneration site to include retail development.
4	The Gorse, Bowdon	3,830	Vacant site with topographical and title difficulties..
5	Partington Library (site of), Central Rd, Partington	1,242	Vacant land adjoining land owned by Peel Developments . Possible joint scheme.
6	Moss View Primary, Moss View Rd, Partington	19,150	Former primary school currently used as offices.
7	Altrincham Depot, Wharf Rd, Altrincham	2,417	Currently in use – may become surplus.
8	65a Roseneath Rd, Urmston	180	1 <sup>st</sup> floor residential flat.
9	Land south of Ingleby Court, Stretford	5,516	Vacant surplus land subject to access issues..
10	Friars Court, Sibson Rd, Sale	1,853	Former Council offices.
11	Stokoe Avenue, Altrincham	4,349	Vacant land part of which is former allotment land. Proposed mixed use scheme.
12	Brentwood School, Altrincham	8,854	Potential development site may be released if Brentwood School re located .

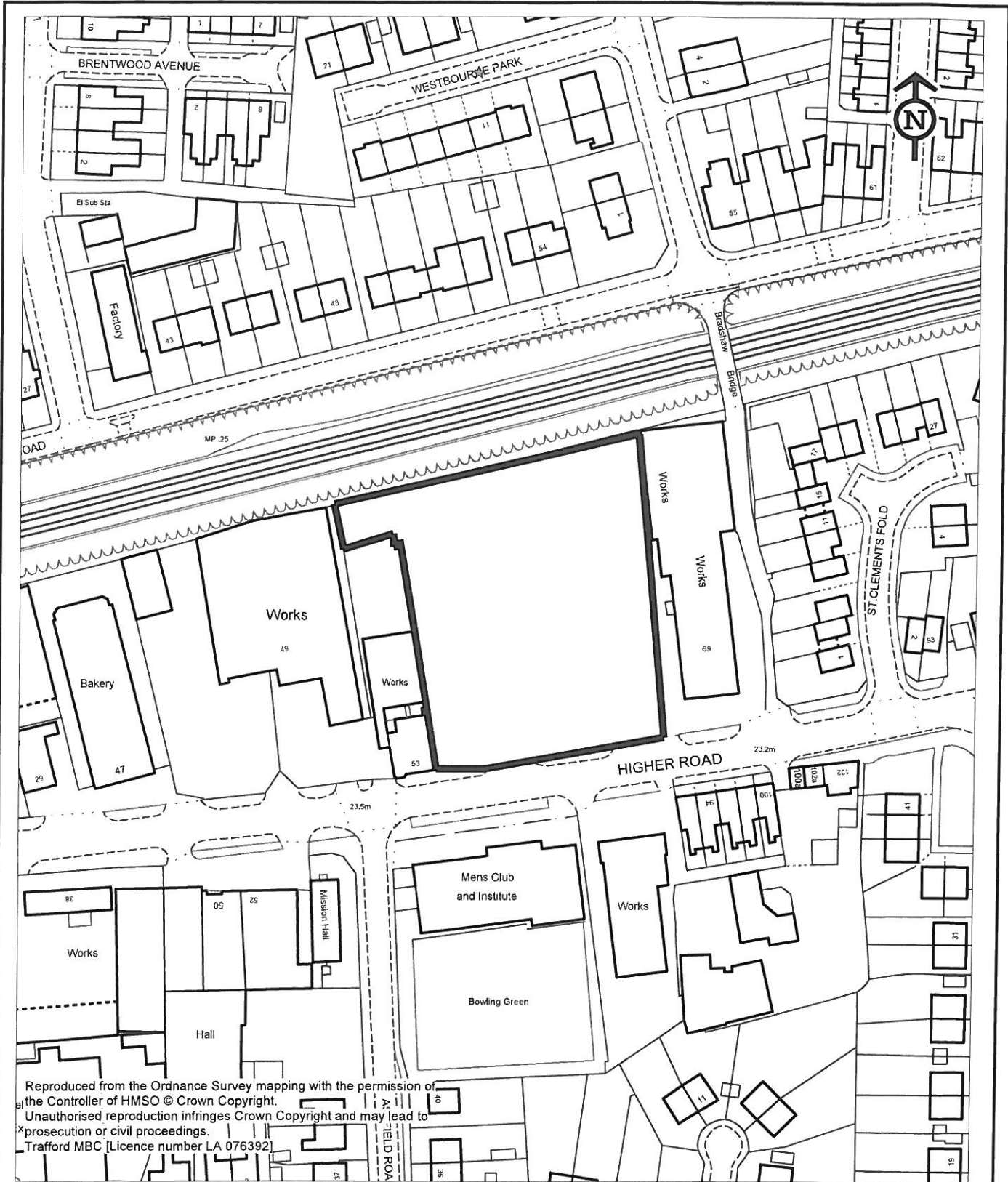

Reproduced from the Ordnance Survey mapping with the permission of the Controller of HMSO © Crown Copyright.  
 Unauthorised reproduction infringes Crown Copyright and may lead to prosecution or civil proceedings.  
 Trafford MBC [Licence number LA 076392]

# TRAFFORD COUNCIL

**HIGHER ROAD DEPOT  
URMSTON**

Scale	1/1250	Date	April 11
Drawn	KI		
Area (or thereabouts):			

File No.  
**713/17F**



Reproduced from the Ordnance Survey mapping with the permission of the Controller of HMSO © Crown Copyright. Unauthorised reproduction infringes Crown Copyright and may lead to prosecution or civil proceedings. Trafford MBC [Licence number LA 076392]

# TRAFFORD COUNCIL

FORMER PARTINGTON DEPOT  
MANCHESTER RD  
PARTINGTON

Scale 1/1250	Date May 11	File No.
Drawn KI		
Area (or thereabouts):		

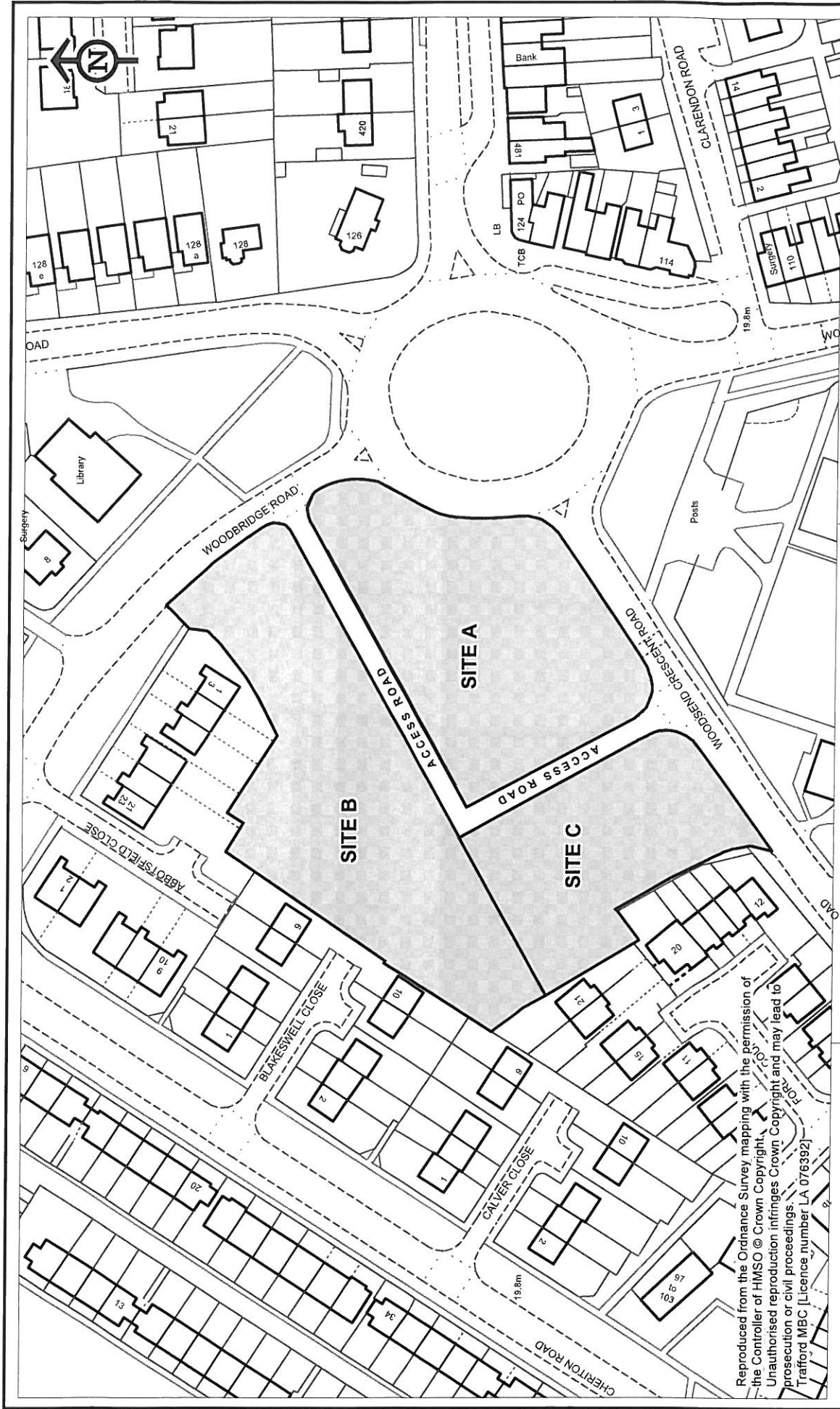

Reproduced from the Ordnance Survey mapping with the permission of the Controller of HMSO © Crown Copyright. Unauthorised reproduction infringes Crown Copyright and may lead to prosecution or civil proceedings. Trafford MBC Licence number LA 076392

File No.

Date April 11

Scale 1/1250

Drawn KI

Area (or thereabouts)

**TRAFFORD COUNCIL**

LAND AT WOODSEND CIRCLE, FLIXTON

746/2C



Reproduced from the Ordnance Survey mapping with the permission of the Controller of HMSO © Crown Copyright. Unauthorised reproduction infringes Crown Copyright and may lead to prosecution or civil proceedings. Trafford MBC [Licence number LA 076392]

# TRAFFORD COUNCIL

LAND AT  
THE GORSE  
BOWDON

Scale 1:1250

Date 23 February 2009

File No.

Drawn

711/360E

Area (or thereabouts):

3747 SQ MTS



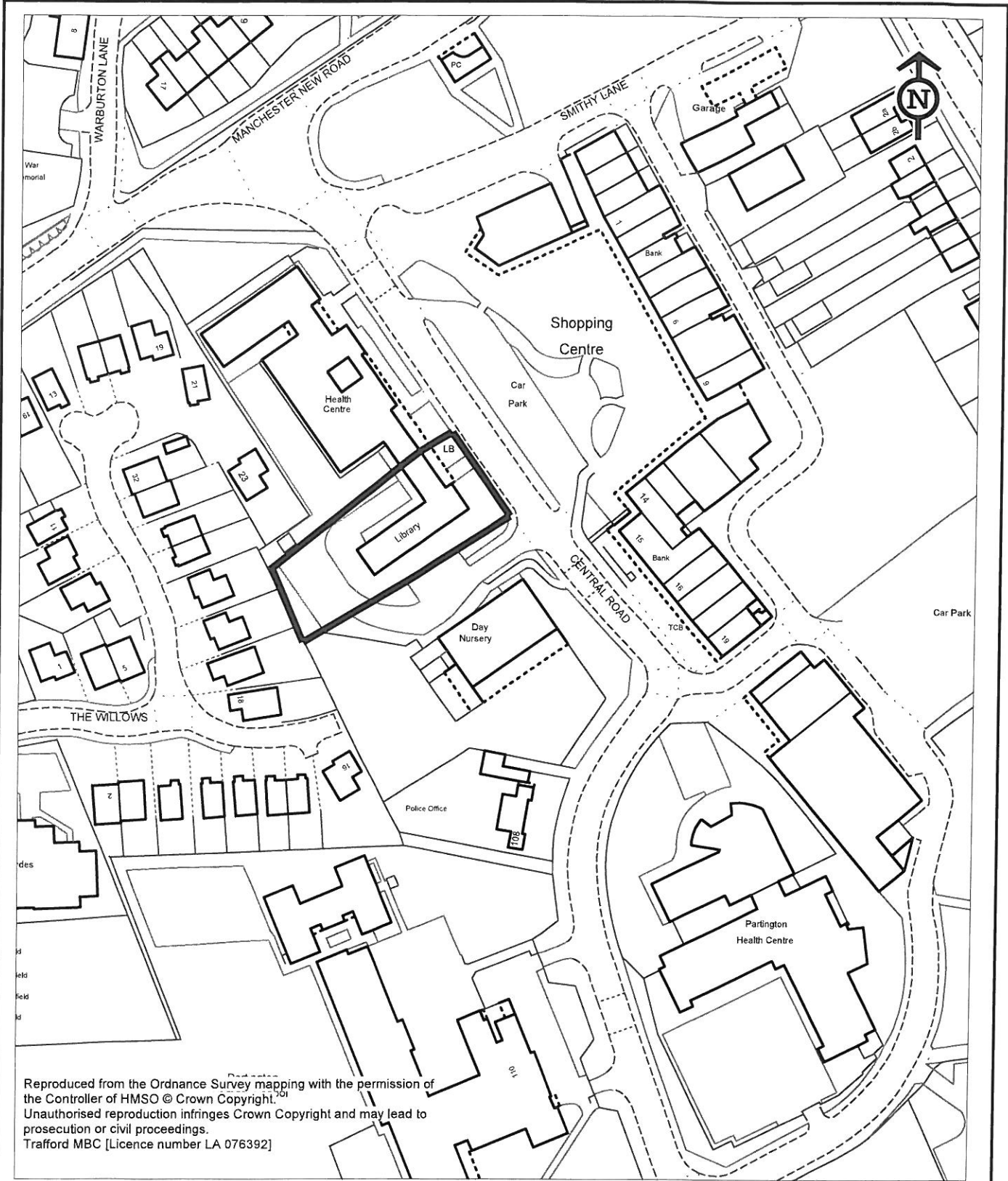

Reproduced from the Ordnance Survey mapping with the permission of the Controller of HMSO © Crown Copyright.  
 Unauthorised reproduction infringes Crown Copyright and may lead to prosecution or civil proceedings.  
 Trafford MBC [Licence number LA 076392]

# TRAFFORD COUNCIL

PARTINGTON LIBRARY  
 CENTRAL ROAD  
 PARTINGTON

Scale	1/1250	Date	May 11	File No.
Drawn	KI			
Area (or thereabouts):				



## TRAFFORD COUNCIL

**MOSS VIEW PRIMARY SCHOOL  
MOSS VIEW ROAD  
PARTINGTON**

Scale 1:2500

Date 22 May 2009

File No.

Drawn

**711/777A**

Area (or thereabouts):

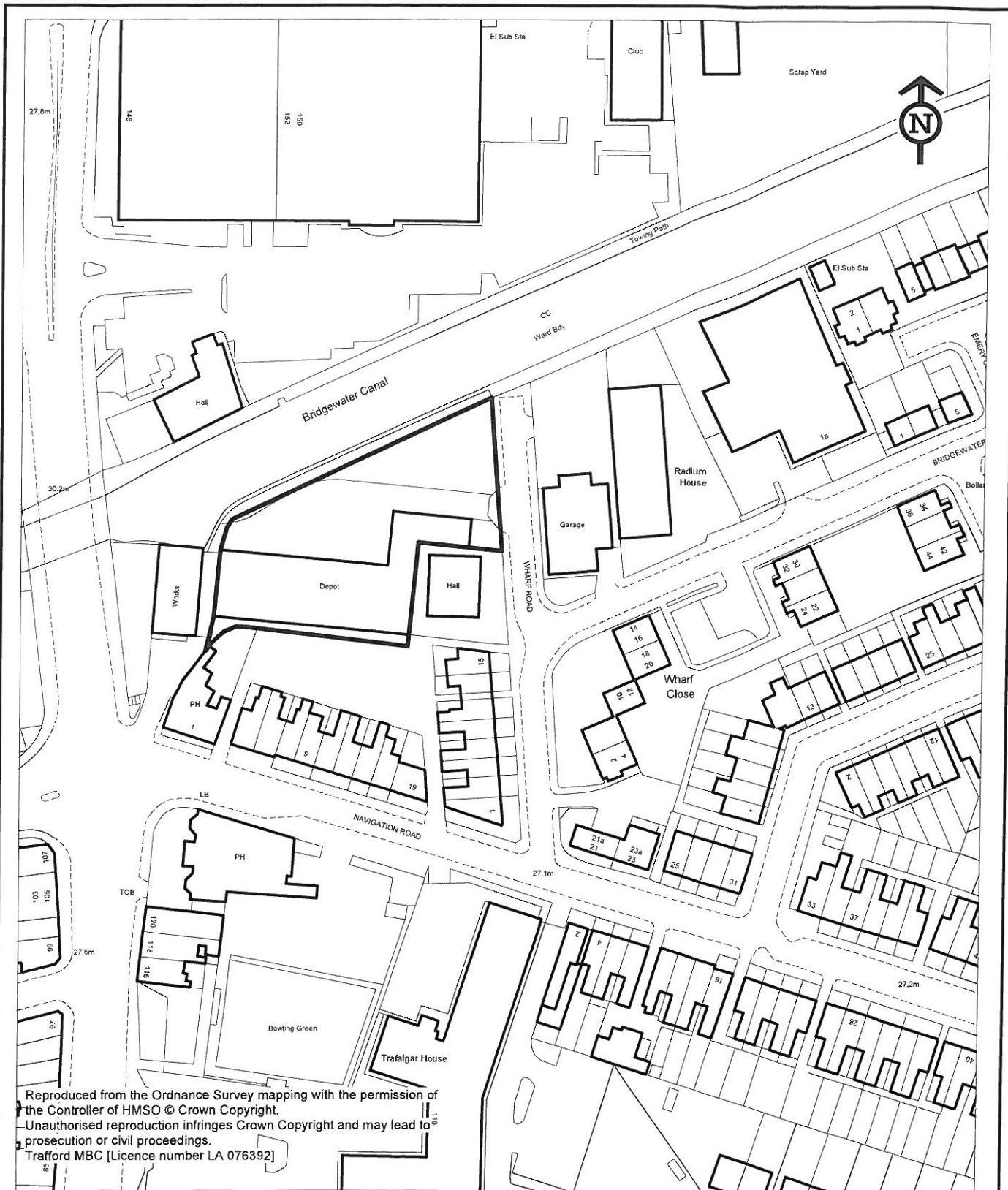

# TRAFFORD COUNCIL

**ALTRINCHAM DEPOT  
WHARF ROAD  
ALTRINCHAM**

Scale 1/1250	Date June 13	File No.
Drawn KI		711/470B
Area (or thereabouts):		





Reproduced from the Ordnance Survey mapping with the permission of the Controller of HMSO © Crown Copyright. Unauthorised reproduction infringes Crown Copyright and may lead to prosecution or civil proceedings. Trafford MBC [Licence number LA 076392]

# TRAFFORD COUNCIL

<b>65A ROSENEATH ROAD</b> <b>URMSTON</b>	Scale <b>1/1250</b>	Date <b>Aug 14</b>	File No.
	Drawn <b>KI</b>		<b>711/807B</b>
	Area (or thereabouts):		

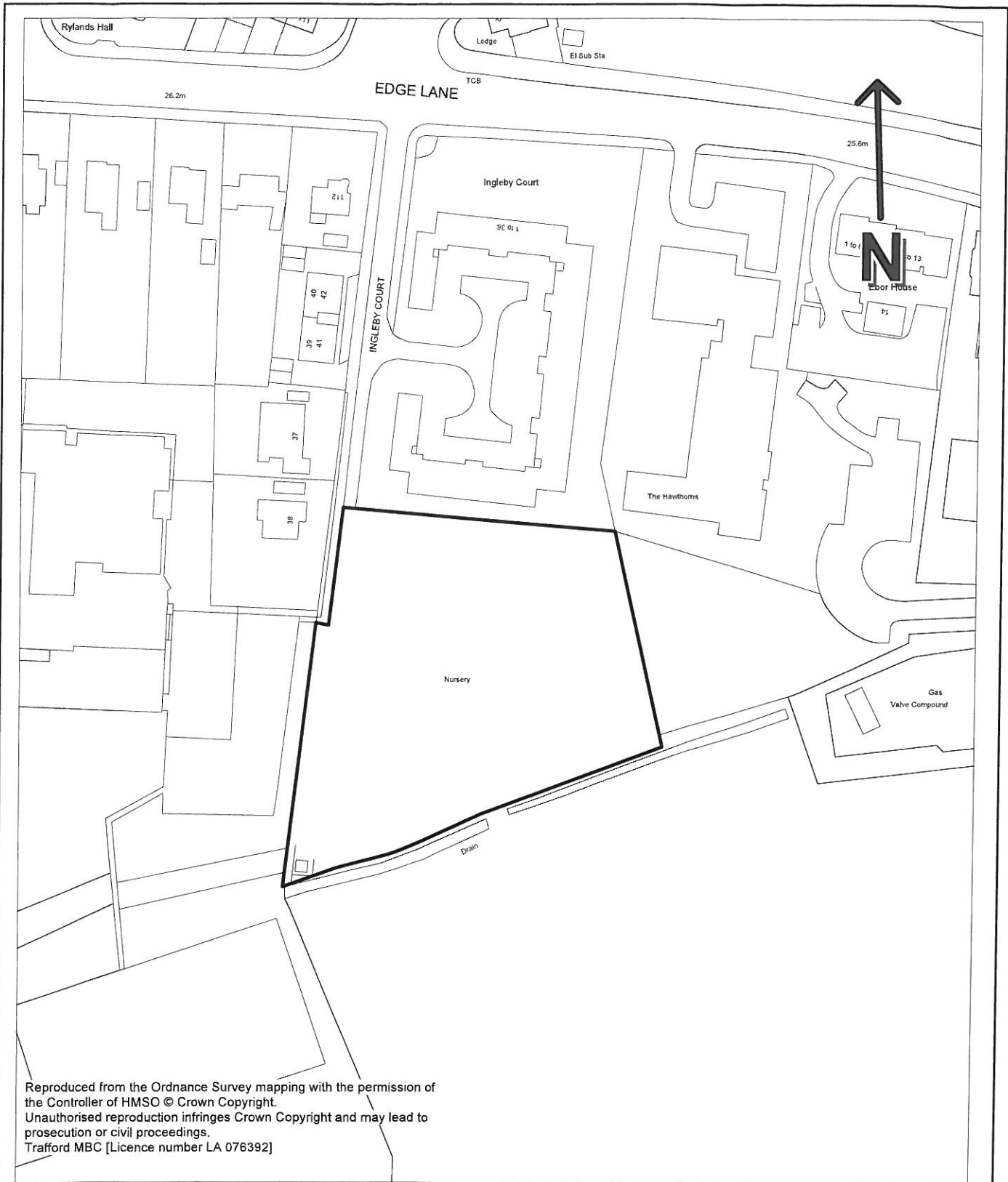

Reproduced from the Ordnance Survey mapping with the permission of the Controller of HMSO © Crown Copyright. Unauthorised reproduction infringes Crown Copyright and may lead to prosecution or civil proceedings. Trafford MBC [Licence number LA 076392]

# TRAFFORD COUNCIL

LAND SOUTH OF  
INGLEBY COURT  
STRETFORD

Scale 1/1250	Date Aug 14	File No.
Drawn KI		
Area (or thereabouts):		

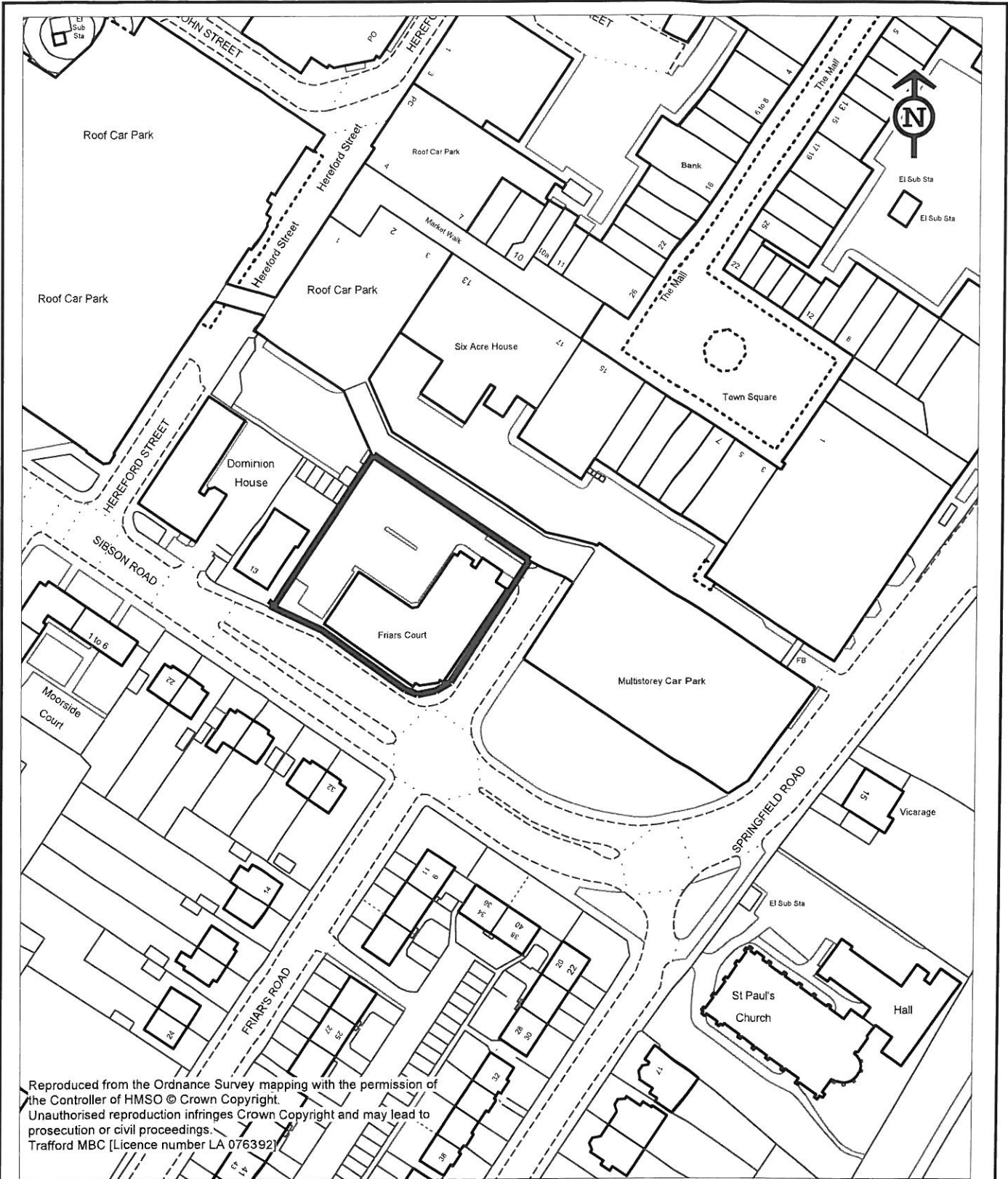

Reproduced from the Ordnance Survey mapping with the permission of the Controller of HMSO © Crown Copyright. Unauthorised reproduction infringes Crown Copyright and may lead to prosecution or civil proceedings. Trafford MBC [Licence number LA 076392]

# TRAFFORD COUNCIL

FRIARS COURT  
SIBSON ROAD  
SALE

Scale 1/1250	Date 08-03-10	File No.
Drawn		
Area (or thereabouts):		



Reproduced from the Ordnance Survey mapping with the permission of the Controller of HMSO © Crown Copyright.  
 Unauthorised reproduction infringes Crown Copyright and may lead to prosecution or civil proceedings.  
 Trafford MBC [Licence number LA 076392]

# TRAFFORD COUNCIL

**LAND AT STOKOE AVENUE  
ALTRINCHAM**

Scale 1/1250	Date 17-03-10	File No.
Drawn KI		711/542F
Area (or thereabouts):		

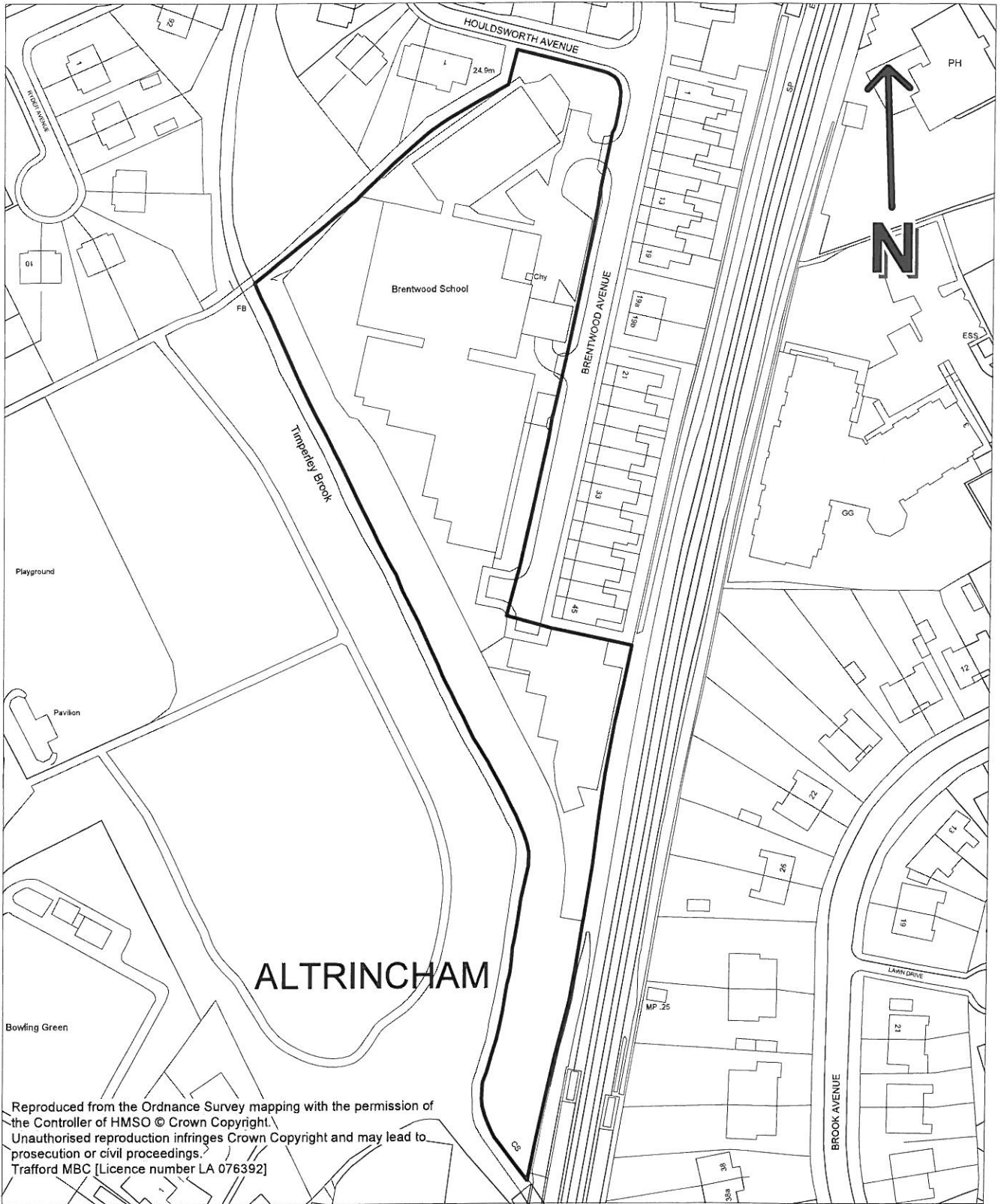

ALTRINCHAM

**TRAFFORD  
COUNCIL**

BRENTWOOD SCHOOL  
BRENTWOOD AVENUE  
ALTRINCHAM

Scale 1/1250	Date Aug 14	File No.
Drawn KI		
Area (or thereabouts):		



## Properties for disposal in 2014-15

	Address	Sq. Mts	Comments
1	3 Kenwood Rd, Stretford	327	Former Children's Home. Now sold.
2	Arcon Place, Altrincham	942	Site of former bungalow. Now sold.
3	Woodfield Rd, Altrincham	1,529	Site of former dwelling houses acquired by CPO . Now sold.
4	9/13 Washway Rd, Sale	919	2 storey former retail property. Now sold.
5	Roseneath Rd, Urmston	925	Site of former dwelling houses acquired by CPO. Now sold, subject to planning .
6	Humphrey Rd, Old Trafford	690	Site of former dwelling houses acquired by CPO Trying resolve encroachment issue with gable wall of adjoining property. To be marketed thereafter.
7	Sinderland Rd, Altrincham	1,785	Surplus vacant land combined with land owned by National Trust.
8	Ortonbrook, Oak Rd, Partington	14,970	Former school site clear of buildings and suitable for residential development.
9	Brook Rd, Flixton (adj 29)	699	Level site suitable for small scale residential development.
10	Denzell Cottages, Bowdon	1,063	Former ancillary buildings to Denzell Hse with potential for residential development.
11	Stretford Public Hall, Chester Rd, Stretford	2,531	Expressions of interest received. Closing date 23 Dec.
12	Old Trafford Supporters Club lease	2,255	Lease of land for car parking in connection with nearby hotel development.
13	Bowfell Hse, Flixton	2,750	Former Flixton library. Potential for residential development.
14	Borough Rd, Altrincham	400	Site of former dwelling houses acquired by CPO. Suitable for residential development.
15	11 Melville Rd, Stretford	306	Former Children's home.
16	56 Langshaw St, Stretford	96	Dwelling house.
17	Cecil Rd, Hale	512	Informal car park with potential for residential development.
18	69 Bowness St, Stretford	82	Dwelling house.
19	Crown Passages, Hale	130	Sale of freehold interest to adjoining owner.
20	71a Chapel Rd, Sale	1,244	Former hostel now used as offices by NHS Mental Health Trust.



## Properties for disposal 2015 and beyond

		Sq.Mts	Comments
1	Higher Road Depot, Higher Rd, Urmston	4,049	Depot currently in use but occupier due to relocate. Potential for residential development.
2	Partington Depot, Manchester Rd, Partington	3,263	Former depot part of which currently occupied by Partington Town Council.
3	Woodsend Circle, Flixton	10,750	Regeneration site to include retail development.
4	The Gorse, Bowdon	3,830	Vacant site with topographical and title difficulties..
5	Partington Library (site of), Central Rd, Partington	1,242	Vacant land adjoining land owned by Peel Developments . Possible joint scheme.
6	Moss View Primary, Moss View Rd, Partington	19,150	Former primary school currently used as offices.
7	Altrincham Depot, Wharf Rd, Altrincham	2,417	Currently in use – may become surplus.
8	65a Roseneath Rd, Urmston	180	1 <sup>st</sup> floor residential flat.
9	Land south of Ingleby Court, Stretford	5,516	Vacant surplus land subject to access issues..
10	Friars Court, Sibson Rd, Sale	1,853	Former Council offices.
11	Stokoe Avenue, Altrincham	4,349	Vacant land part of which is former allotment land. Proposed mixed use scheme.
12	Brentwood School, Altrincham	8,854	Potential development site may be released if Brentwood School re located .



## Properties for disposal 2015 and beyond

		Sq.Mts	Comments
1	Higher Road Depot, Higher Rd, Urmston	4,049	Depot currently in use but occupier due to relocate. Potential for residential development.
2	Partington Depot, Manchester Rd, Partington	3,263	Former depot part of which currently occupied by Partington Town Council.
3	Woodsend Circle, Flixton	10,750	Regeneration site to include retail development.
4	The Gorse, Bowdon	3,830	Vacant site with topographical and title difficulties..
5	Partington Library (site of), Central Rd, Partington	1,242	Vacant land adjoining land owned by Peel Developments . Possible joint scheme.
6	Moss View Primary, Moss View Rd, Partington	19,150	Former primary school currently used as offices.
7	Altrincham Depot, Wharf Rd, Altrincham	2,417	Currently in use – may become surplus.
8	65a Roseneath Rd, Urmston	180	1 <sup>st</sup> floor residential flat.
9	Land south of Ingleby Court, Stretford	5,516	Vacant surplus land subject to access issues..
10	Friars Court, Sibson Rd, Sale	1,853	Former Council offices.
11	Stokoe Avenue, Altrincham	4,349	Vacant land part of which is former allotment land. Proposed mixed use scheme.
12	Brentwood School, Altrincham	8,854	Potential development site may be released if Brentwood School re located .



